

Split Core Current Transformers and Transducers

Benefits

- » Installation without interrupting the supply
- » Reduced installation time
- » Self-extinguishing case
- » Easy to install and connect
- » Compact size
- » Tamper protection
- » Burden according to accuracy

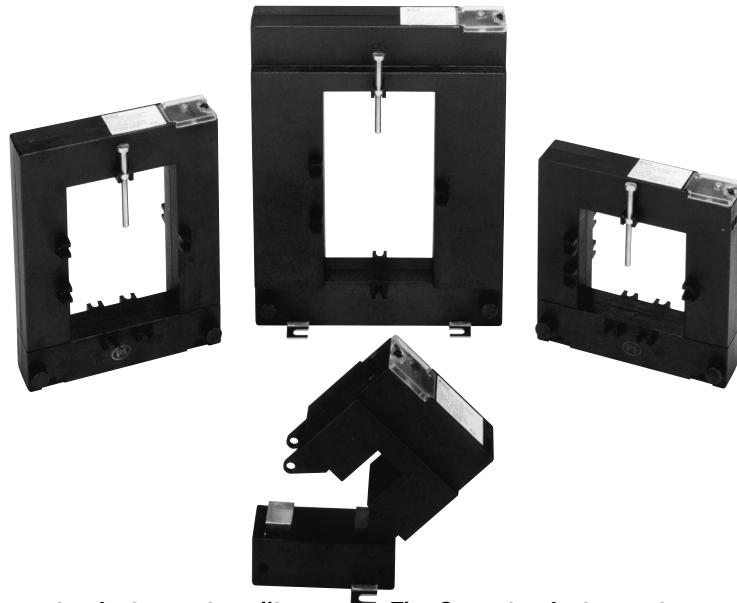

The Crompton Instruments split core current transformer offers cost effective and efficient method by which current can be measured without the need to break into the conductor, thereby reducing installation and commissioning time. They are ideally suited for use on installations where supply interruption is not possible or where conductor integrity cannot be hindered.

The Crompton Instruments range of split current transducers offers a cost effective and efficient method by which current can be measured and converted into a 4/20 mA signal. The range eliminates the need for a separate current transducer therefore reducing on installation time and component cost. They are ideally suited for use on installations where supply interruption is not possible or where conductor integrity cannot be hindered.

Description

Maximum voltage (A.C.):	0.72 kV	Thermal class:	A
Rated insulation level:	3 kV	Use:	Indoor
Frequency response:	50 - 60 Hz, linear	ABS coating:	Self-extinguishing (UL94V0)
Ratings:		Secondary terminal box:	Sealable
Short-time thermal current:	60	Standards:	IEC 44-1, UNE 21 088-1, UL 94, VDE0414
Dynamic current:	2.5		
Overload:	120% for 5 secs		

Dimensions (mm's)

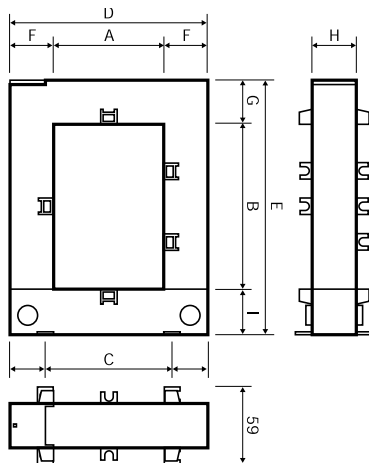

Model	Case 1	Case 2	Case 3	Case 4	Case 5
A	20	50	80	80	80
B	30	80	80	120	160
C	51	78	108	108	120
D	89	114	144	144	184
E	110	145	145	185	245
F	34	32	32	32	52
G	47	32	32	32	47
H	40	32	32	32	52
I	32	33	33	33	38
Weight (kg)	0.75	0.9	1.0	1.2	3.5

Split Core Current Transformers and Transducers

Transformers and Transducers

Features

- » Installation without interrupting the supply
- » From 100 A to 5000 A with a 5 A secondary
- » Large conductor aperture
- » Easy to install and connect
- » Sealable terminal cover
- » Compact size
- » High accuracy and reliability

	Part No.	Primary A	Burden VA against class index			Apperture Busbar/Cable (mm)
			0.5	1	3	
Case 1	SCPKLSCA1	100/5	-	-	1.5	20 x 30
	SCPZLSCA1	150/5	-	-	2	20 x 30
	SCRLLSCA1	200/5	-	1.5	2.5	20 x 30
	SCRSLSCA1	250/5	-	2	4	20 x 30
	SCRXLSCA1	300/5	1.5	4	6	20 x 30
	SCSCLSCA1	400/5	2.5	6	10	20 x 30
Case 2	SCRSLSCA2	250/5	1	2	4	50 x 80
	SCRXLSCA2	300/5	1.5	3	6	50 x 80
	SCSCLSCA2	400/5	1.5	3	10	50 x 80
	SCSFLSCA2	500/5	2.5	5	15	50 x 80
	SCSJLSCA2	600/5	2.5	5	17.5	50 x 80
	SCSMLSCA2	700/5	3	6	18	50 x 80
	SCSNLSCA2	800/5	3	7	18	50 x 80
	SCSSLSCA2	1000/5	5	10	20	50 x 80
Case 3	SCRSLSCA3	250/5	1	2	4	80 x 80
	SCRXLSCA3	300/5	1.5	3	6	80 x 80
	SCSCLSCA3	400/5	1.5	3	10	80 x 80
	SCSFLSCA3	500/5	2.5	5	15	80 x 80
	SCSJLSCA3	600/5	2.5	5	17.5	80 x 80
	SCSMLSCA3	750/5	3	6	18	80 x 80
	SCSNLSCA3	800/5	3	7	18	80 x 80
	SCSSLSCA3	1000/5	5	10	20	80 x 80
Case 4	SCSFLSCA4	500/5	-	4	12	80 x 120
	SCSJLSCA4	600/5	-	5	14	80 x 120
	SCSMLSCA4	750/5	2.5	6	17	80 x 120
	SCSNLSCA4	800/5	3	7	18	80 x 120
	SCSSLSCA4	1000/5	5	9	20	80 x 120
	SCSULSCA4	1200/5	6	11	24	80 x 120
	SCSVLSCA4	1250/5	7	15	28	80 x 120
	SCTCLSCA4	1500/5	8	17	30	80 x 120
Case 5	SCSSLSCA5	1000/5	10	15	20	80 x 160
	SCTCLSCA5	1500/5	15	20	25	80 x 160
	SCTMLSCA5	2000/5	15	20	25	80 x 160
	SCTULSCA5	2500/5	15	20	25	80 x 160
	SCUJLSCA5	3000/5	20	25	30	80 x 160
	SCXZLSCA5	4000/5	20	25	30	80 x 160
	SCUJLSCA5	5000/5	20	25	30	80 x 160

Split Core Current Transformers and Transducers

Transformers and Transducers

The SCHG Series of transformer-converters also benefit from the split core design. The SCHG Series modules do not include the supply source; they must be supplied with 10 - 28V D.C. source. D.C. power supply burden 0.3VA. Overload 120% for 5 seconds.

Features

- » Installation without interrupting the supply
- » From 5 A to 4000 A with a 4/20 mA secondary
- » Eliminates need for separate current transducer
- » Reduced installation time
- » Sealable terminal cover
- » Compact size

	Part No.	Primary A	Apperature Busbar/Cable (mm)
Case 1	SCLSHGCA1	5	20 x 30
	SCMTHGCA1	10	20 x 30
	SCRSHGCA1	20	20 x 30
	SCNGHGCA1	50	20 x 30
	SCPKHGCA1	100	20 x 30
	SCRLHGCA1	200	20 x 30
	SCRSHGCA1	250	20 x 30
	SCSFHGCA1	500	20 x 30
Case 2	SCPKHGCA2	100	50 x 80
	SCRSHGCA2	250	50 x 80
	SCSFHGCA2	500	50 x 80
	SCLSHGCA2	750	50 x 80
Case 3	SCPKHGCA3	100	80 x 80
	SCRSHGCA3	250	80 x 80
	SCSFHGCA3	500	80 x 80
	SCLSHGCA3	750	80 x 80
	SCSSHGCA3	1000	80 x 80
	SCTCHGCA3	1500	80 x 80
Case 4	SCRSHGCA4	250	80 x 120
	SCSFHGCA4	500	80 x 120
	SCLSHGCA4	750	80 x 120
	SCSSHGCA4	1000	80 x 120
	SCTCHGCA4	1500	80 x 120
Case 5	SCSFHGCA5	500	80 x 160
	SCLSHGCA5	750	80 x 160
	SCSSHGCA5	1000	80 x 160
	SCTCHGCA5	1500	80 x 160
	SCTMHGCA5	2000	80 x 160
	SCUJHGCA5	3000	80 x 160
	SCXZHGCA5	4000	80 x 160